

# UNFLANGED COAXIAL ADAPTORS ZERO CUT

## FEATURES

- unflanged coaxial adaptors
- low insertion losses
- low V.S.W.R
- indoor applications

## GENERAL FEATURES

FREQUENCY RANGE	0.1 ÷ 860 MHz	
IMPEDANCE	50 ohm	
RETURN LOSS	≥ 32 dB	
MAX MEAN POWER	See table below	
OPERATING TEMPERATURE RANGE	-40 to +70° C (-40 to +158° F)	
CONNECTORS	See table	
WEIGHT	See table	
MATERIALS	- External body	Copper,Brass, Aluminium*
	- Inner conductor	Silver plated brass, copper
	- Insulator	Teflon
EXTERNAL FINISHING	Painted RAL 7001, Nickel plating	

## MAX MEAN POWER

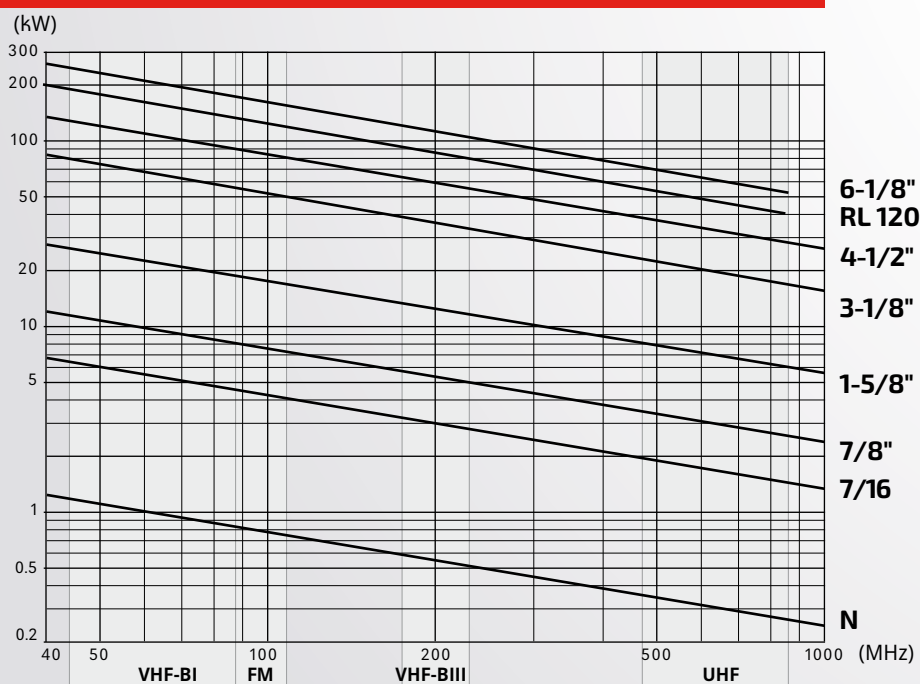

### STANDARD CONDITIONS:

- V.S.W.R. = 1.0
- Ambient temperature 40°C (104°F)
- Atmospheric Pressure, dry air
- Inner Conductor Temperature 120°C (248°F)



# UNFLANGED COAXIAL ADAPTORS ZERO CUT

figure "1"

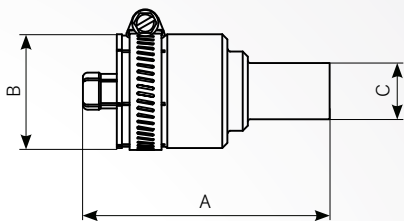

figure "2"

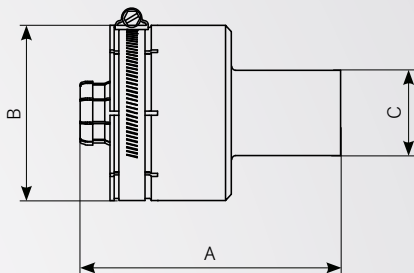

figure "3"

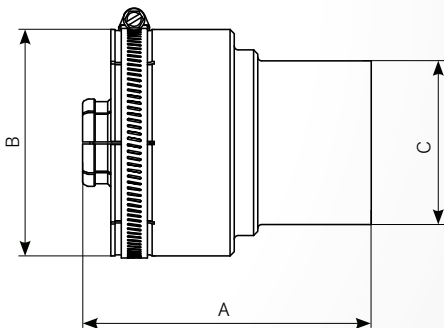
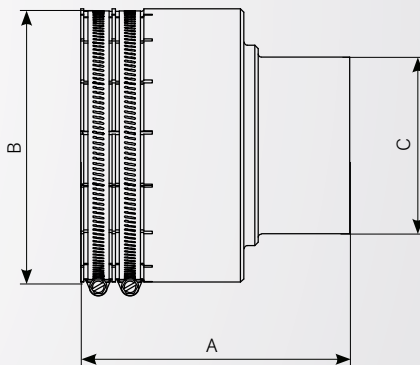

figure "4"



## UNFLANGED COAXIAL ADAPTORS ZERO CUT

TYPE	CONNECTORS		FIGURE	DIMENSIONS			WEIGHT
				A mm (in)	B mm (in)	C mm (in)	
TRS-40/U/Z*	1-5/8" Unfl. M	7/8" Unfl. F	1	97.8 (3.9)	45 (1.8)	22.3 (0.88)	0.2 (0.44)
TRS-17/U/Z	3-1/8" Unfl. M	1-5/8" Unfl. F	2	126.5 (5)	85 (3.3)	41.3 (1.63)	0.7 (1.5)
TRS-42/U/Z	4-1/2" Unfl. M	3-1/8" Unfl. F	3	140 (5.5)	110 (4.3)	79.4 (3.13)	1.2 (2.6)
TRS-41/U/Z	6-1/8" Unfl. M	4-1/2" Unfl. F	4	161.5 (6.4)	164 (6.5)	106 (4.17)	3.1 (6.8)

Note: F = female / M = male